



NOTE: THE LOCATION OF B.E.J. COLLEGE IS CHANGED FROM SY. NO. 499 TO 461 AS PER THE DIRECTIONS OF THE R.D.T.P. CONSEQUENT TO THE GROUND VERIFICATION VIDE FILE NO. 554/14/62.

1. THE C.L.U. FROM RESIDENTIAL LAND USE TO PUBLIC & SEMI PUBLIC LAND USE VIDE T/O LT. R. O.C. NO. 3347/14-82, DT. 26.5.2014. IN S. NO. 45/8/1B & 2B TO AN EXTENT AC. 1.875 CENTS.

2. THE C.L.U. FROM COMMERCIAL LAND USE TO RESIDENTIAL LAND USE VIDE T/O LT. R. O.C. NO. 439/16/62, DT. 26.6.16 IN S. NO. 20/541/9A2, 9A3, 9A4 TO AN EXTENT AC. 0.62 CENTS. VIDE C.L.U. NO. 8 DT. 2.6.16.

NOTE: DEMARCATION OF EXISTING N.S.P. CANAL PORTION AND ADJACENT 100' WIDE PROPOSED ILUP ROAD ALONG THE N.S.P. CANAL AT SY. NO. 277, 218, 229 & 240 WERE RECTIFIED AS PER THE DIRECTION OF D.T.S.P. GUNTUR AS PER THEIR LT. R. O.C. NO. 4048/2015/8 DT. 26.10.2015 BY REFERRING THE ENCLOSED FMB RECORDS.

THE C.L.U. FROM INDUSTRIAL LAND USE TO RESIDENTIAL LAND USE VIDE LT. R. O.C. NO. 871/2016/G, DT. 5.1.2019 IN S. NO. 375/3A & 3B TO AN EXTENT AC. 2.02 CENTS.

**DARSI**  
**MANDAL HEAD QUARTER**  
**PRAKASAM DISTRICT**

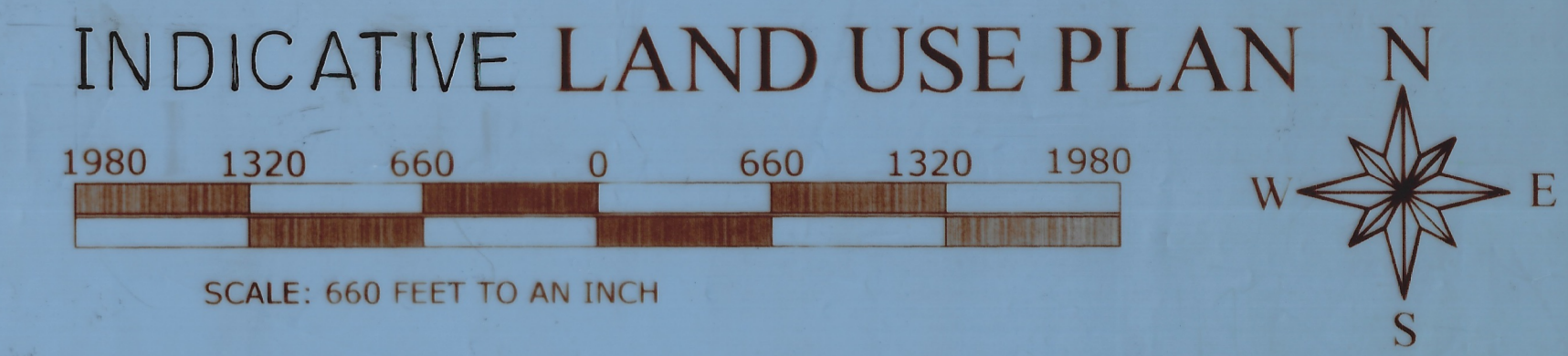

**LEGEND**

	ACRES	PERCENTAGE
RESIDENTIAL LAND USE	194.759	59.43
COMMERCIAL LAND USE	6.100	2.47
INDUSTRIAL LAND USE	322.50	9.84
PUBLIC & SEMI PUBLIC LAND USE	120.00	3.66
ROADS	259.50	7.92
TRANSPORTING & COMMUNICATION	18.21	0.56
GRAVE YARDS	4.00	0.12
WATER COURSES	191.70	5.85
URBANISABLE LAND USE	332.50	10.15
<b>TOTAL</b>	<b>3277.00</b>	<b>100.00</b>
VILLAGE BOUNDARY		
LAND USE BOUNDARY		

*[Signature]*  
 DIRECTOR OF TOWN AND COUNTRY PLANNING  
 HYDERABAD, GOVT. ANDHRA PRADESH

*[Signature]*  
 DEPUTY DIRECTOR

*[Signature]*  
 JOINT DIRECTOR

REGIONAL DEPUTY DIRECTOR OF TOWN AND  
 COUNTRY PLANNING, GUNTUR, GOVT. OF A.P.

(VACANT)  
 T.P. ASSIST.

*[Signature]*  
 ASSIST. DIRECTOR

A.A.D.

*[Signature]*  
 A.D.M.

*[Signature]*  
 A.D.M.